

— The Red lines represent the prior Survey made to John Whitner
 - - - - - The black & dotted lines represent Lutzinbizers Survey

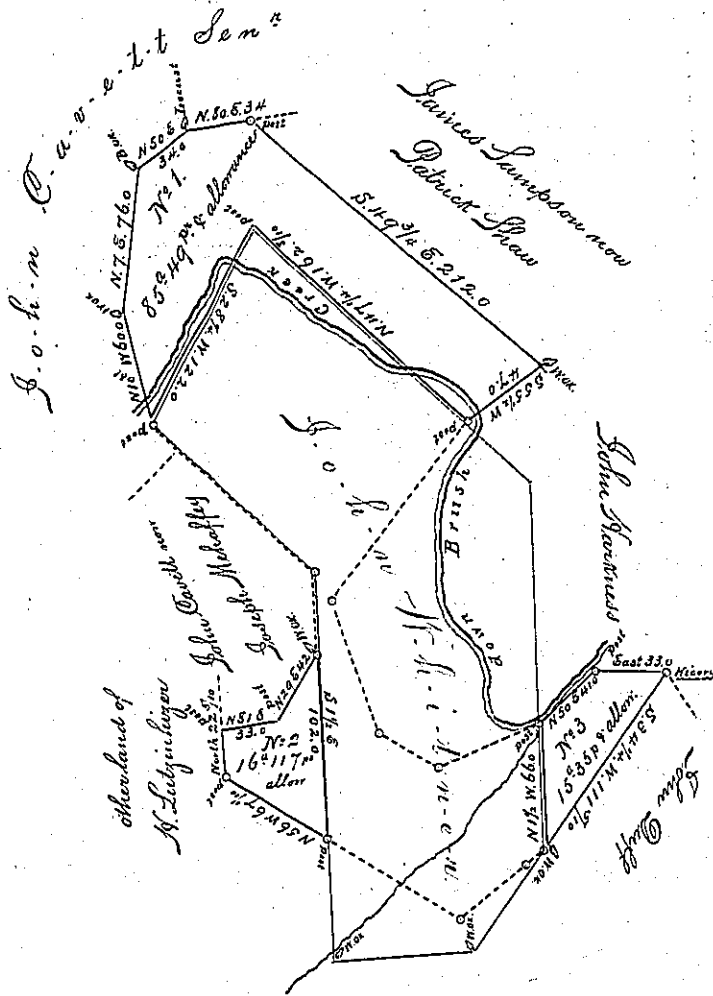

N.B. The order of Recovery was directed to James Murray D.S. who was on the ground
 and Mr. Lutzinbizer says he made no return upon it & I have no evidence to the contrary

March 18th & 19th 1834. In pursuance of an order of the Board of Property granted to Newry Lutzinbizer dated May 10th 1814. I retraced the above lines of surveys one made by John Moore D. S. for Newry Lutzinbizer April 20th 1803 containing 321^{ac} & allowance, and the other a prior survey made by Wm Thompson D.S. on an order granted to John Whitner No 2924 dated the 7th day of April 1769 to contain 257^{ac} & allowance. And Ascertained the interference of the two surveys to be as above represented, and that Whitners Survey excludes and only leaves to Newry Lutzinbizers Survey the three fractions of ground represented by lines drawn with black Ink, containing collectively One hundred & seventeen acres & forty one perches & the usual allowance of six p^{ts} of a Rod for Roads &c. Situate on the waters of Brush Creek in North Huntingdon Township Westmoreland County Pa.
 To Jacob Spangler, Esquire }
 Surveyor Gen^l Com. Pa. }

C. Fullwood D.S.

IN TESTIMONY that the above is a copy of the original remaining on file in the Department of Internal Affairs of Pennsylvania, made conformably to an Act of Assembly approved the 16th day of February, 1833, I have hereunto set my Hand and caused the Seal of said Department to be affixed at Harrisburg, this

18th day of June 1897

James W. Fitter
 Secretary of Internal Affairs